

# Radiva Crystal Glass Radiator

## Installation and User Guide



# Table of contents

- 1. INSTALLATION.....page 3
  - 1.1 Precautions before installation.....page 3
  - 1.2 General Cleaning Instructions.....page 3
  - 1.3 Safe distances for installation.....page 4
  - 1.4 Wall Mounting.....page 4
  - 1.5 Covering the Junction Box (Optional) .....page 8
  - 1.6 Electrical Installation.....page 9
- 2. IMPORTANT SAFETY INSTRUCTIONS .....page 9
- 3. TROUBLESHOOTING.....page 9
- 4. TECHNICAL DATA ..... page 10
- 5. WARRANTY DECLARATION ..... page 10
- WARRANTY CERTIFICATE..... page 11

## 1. INSTALLATION

Warning : The radiator must be installed by a professional or someone competent who has first checked to make sure the electricity supply meets current norms.

Our responsibility is limited to the supply of the radiator.

### 1.1 Precautions before installation

- On the panel, make sure the power cable is not damaged. If it is, it must be replaced by a qualified person because special tools are needed.
- Never install the radiator just below a power outlet.
- Classified as a fixed heating device, the Radiva Crystal Glass Radiators must only be fixed to the wall. The manufacturer must be consulted before any other form of installation is attempted.
- The radiator must not be installed if the glass is damaged.
- Electrical appliances must principally be placed at a minimum distance of 0.6 m to the next mains water supply.
- Independent heaters such as Radiva Crystal Glass Radiators may not be used in the direct vicinity of a bath tub, a shower or a swimming pool. In addition it should be observed when assembling independent heaters in bathrooms that they are attached or fastened in such a way that the switch and controller cannot be touched by someone in the bath or the shower .

### 1.2 General Cleaning Instructions

For the removal of stains or films, as sometimes arise in the living or bath areas, the glass surfaces of SGG THERMOVIT ® elegance heating radiators are generally cleaned in the same way as the other glass surfaces in the household (window glass, table surfaces or mirrors).

The surfaces can simply be rubbed clean with a damp chamois leather that has been washed in warm water and well wrung out.

You should ensure that no water remains permanently on the edges of the heating radiator or is allowed to react with it.

We expressly advise against the use of caustic detergents or detergents, which contain solvents.

### 1.3 Safe Distances for Installation

- Distance of the lower edge of the appliance from the floor must not be smaller than 50 mm, 150 mm recommended. Distance sidelong, e.g. to furniture, must be minimum 100 mm (see picture 2). In Bathrooms, the panel must be installed in conformity with IEC 364-7-701:1984 and may be located in compliance with the picture 1 in the zones 2 and 3. The panel is gadget of the class II and is protected against powerful water jets, protection IP x6. The panel must not be located directly under mains outlet. Electrical installation is to be equipped with double pole switch, by which the distance of open contacts is equal to min. 3 mm.
- The panel can be installed on the wall lengthwise or widthwise; mounting the panel on the ceiling is forbidden .

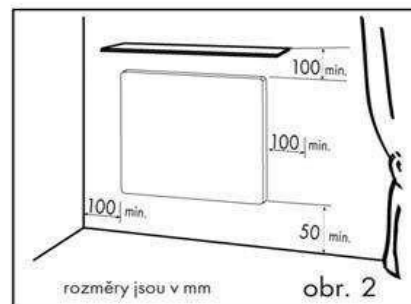
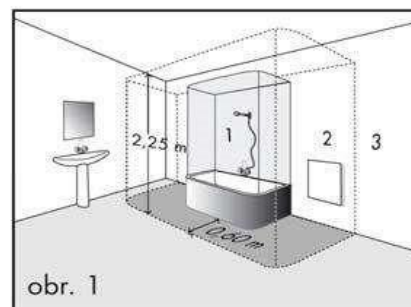

### 1.4 Wall Mounting

The following are delivered for the wall mounting:

- Four stainless steel wall holders consisting of one adapter piece (Part A) and one glass holder (Part B) respectively .



- 2) An Allen key
- 3) Four standard dowels for solid stone masonry
- 4) Four standard screws

Tool Required :

Tape measure or folding meter rule  
 Spirit Level  
 Pencil  
 Drill  
 Drill Bit Ø 10 mm  
 Screwdriver

Assembly of the wall holders

- 1) To begin with select an appropriate position for your Radiva Crystal Glass Radiator on your wall. Use the mounting template to position the glass radiator. You can mount vertically or horizontally. In this process observe that the mains sockets necessary for the operation of the glass heating element is within the cable length of 1.5 meters. In addition observe the heating element mains socket must have a minimum distance of 60cm to the next water source for safety reasons and may not be attached beneath the mains socket. The connecting cable can be shortened by an expert and connected to an appropriately positioned wall connection .
- 2) Put the mounting template on wall and label the 4 drilling positions on the wall (vertical or horizontal) . Use spirit level for leveling.

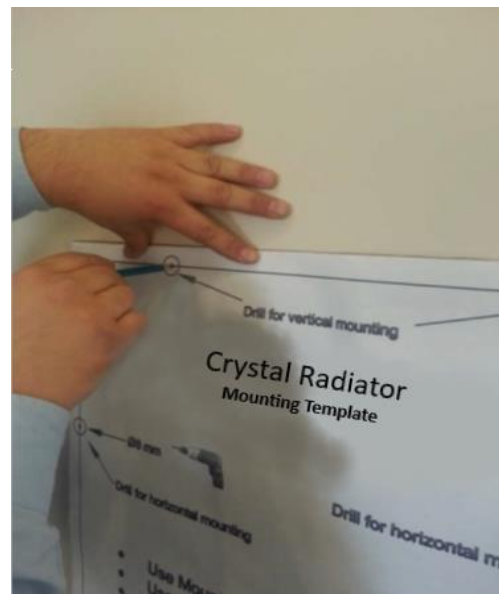

- 3) Drill the four drilling positions just marked out with the 10 mm drill and following this guide the dowel into the hole .  
 Please observe that the dowels that come with the delivery are standard dowels, which are only suitable for anchoring in solid building blocks.

If the wall is made of porous chalky sandstones or similar stones there is the risk that the dowels that came with the delivery will be pulled out of the wall. In this case obtain appropriate dowels for your wall from a specialist store.



- 4) Place the four adapter pieces (part A) on the hole like in the picture . Screw down adapter pieces (part A) by using the screws come with the heating element. Repeat the process for all 4 drilling positions.



- 5) Now place the corresponding glass holders (part B) upon the lower adapter pieces(part A) and slightly tighten the fastening screws attached to the side with the Allen key that comes with the delivery.

**PLEASE NOTE !!!** At this stage, just mount the lower glass holder(part B) . Upper two glass holders (parts B) will be installed later.

**PLEASE NOTE !!!** Make sure that mounting parts are correctly fixed before moving to the next steps !



- 6) Insert the Radiva Crystal Glass Radiator panel into the two lower glass holders(Part B). Make sure the heating panel is centered correctly. Center it by using the meter ruler.



- 7) Loosely place the two remaining glass holders upon the upper glass edge. While keeping the lower edge of the heating element inside the lower glass holders, move the panel towards the wall until the upper adapter pieces(part A) inserted into the upper glass holders ( part B).  
**PLEASE NOTE !!!** Hold the heating panel until you fasten all four glass holders correctly. Otherwise the heating panel can fall.



- 8) Now, slightly tighten the fastening screws attached to the side of the upper glass holders (Part B) with the Allen key that comes with the delivery.



- 9) Your Radiva Crystal Glass Radiator is now ready for use.

### 1.5 Covering the Junction Box (Optional)

Stainless steel U shaped plate can be used optionally as a cover to make the resulting cable unseen as shown in the figure below.

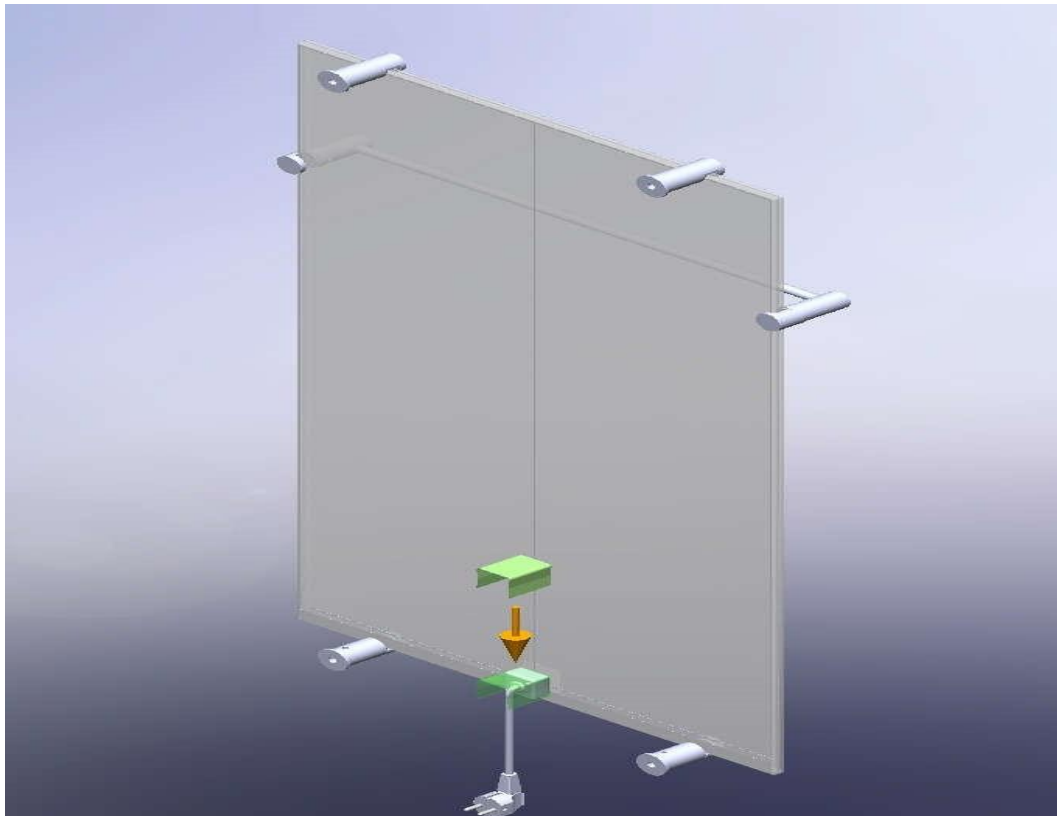



## 1.6 Electrical Installation

Radiva Crystal Glass Radiators can only be connected to 220-240V - 50 hz AC current. The appliance is connected directly to the power inlet provided for the purpose. An earth is not necessary given that the products are in class II (see paragraph 1.b)



## 2. Important safety instructions – WARNING

- Never cover the radiator: risk of overheating
- Never use abrasive or corrosive products
- If a fault should arise with your heating radiator please contact your supplier or contact the manufacturer directly. For the processing of the complaint please note down the model and the series number of the heating radiator, which you will find on the sticker on the connecting box on the rear side of the heating radiator .
- It is not allowed to place any furniture or to hang curtains before panel (see picture) and free air circulation must be ensured.
- Regularly, at least before beginning of heating period, you should remove dust from the panel. Do not touch the panel from the bath or shower!
- If the glass is damaged, the heating device cannot be used
- Switch off the power supply and unplug the radiator before cleaning.
- Children should be supervised to ensure that they do not play with the appliance.
- Cleaning and maintenance of the radiator can not be done by children
- This appliance is not intended for use by persons (including children) with reduced physical, sensory, or mental capabilities, or lack of experience and knowledge, unless they have been given supervision or instruction concerning the use of the appliance by a person responsible for their safety.
- Do not sit or stand on the radiator.

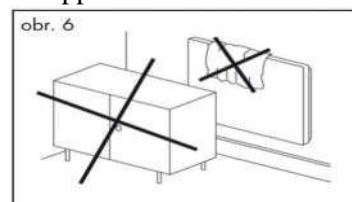

## 3. Troubleshooting

- Check the power supply
- Cut the radiator power supply until the radiator is cold
- Call a technician
- In case of glass breakage , do not connect the radiator power supply .

#### 4. Technical Data

MODEL	Dimensions (mm) (LxWxD)	Weight(kg)	Power(W)	Current(A)	Voltage(V) AC	Protection Class	Protection
500 (CC,WD,BP,M)	560 x 10130 x 13	18	550	2,2	230	II	IP X6
750 (CC,WD,BP,M)	760 x 1030 x 13	25	750	3,4	230	II	IP X6
1000 (CC,WD,BP,M)	1010x1030 x 13	34	1000	4,5	230	II	IP X6

#### 5. Warranty declaration

Radiva provides a warranty of 24 months against provable manufacturing and material faults for every heating radiator manufactured and sold by them. The start of the guarantee period is the sales date proved by the specialist retailer.

This warranty only applies if we are informed immediately of the faults immediately after you notice them and if: the warranty section on the rear has been completely filled and stamped by the trader, who issued or delivered the appliance, and provided with the purchase date. the original model description on the connecting box of the heating radiator has not been removed or made illegible, the operating and assembly instructions enclosed by us were observed and culpability of the purchaser for the faults can be ruled out. Liability for damage, which was caused by the appliance or the use of the appliance, due to improper use or operation of the appliance, due to incorrect or inappropriate connection of it or due to interference or attempts to repair it, are excluded from the warranty. Complaints, which are due to wear and tear (for instance excess-voltage) are also excluded.

The guarantee does not refer to defects caused by transport, careless handling and unauthorized mounting. The guarantee does not also refer to unauthorized intervention in panel and to ordinary wear and tear of the product.

In the event of a justified complaint in accordance with the warranty we are obliged to rectify the fault or make a spare part delivery.

In addition to the rights from this warranty the purchaser is additionally to its statutory rights due to a liability for material defects or due to product liability.



## WARRANTY CERTIFICATE

In order to validate your 2 year contractual warranty in accordance with the specified warranty conditions stated in the Radiva Crystal Glass Radiators user manual, please complete and return this warranty certificate within 15 days from the date of purchase to the following address :

Modell | Modèle | Model:

Serien - Nr. | Numéro de série | Series no.:

Kaufdatum | Date d'achat | Purchase date :

Beanstandung | Réclamation | Complaint:



## Attestation of Conformity

### No.: L13 13P10006 0064

<b>Holder of Certificate:</b>	<b>BİLLUR CAM END.LTD.</b> Adnan Kahveci Cad. Omerli Hadimköy 34870 Istanbul/Türkiye
<b>Product:</b>	Glass Radiator Heater
<b>Brand (s) /Model(s):</b>	Q-Artz Thermolamex <b>CC, WD, BP, M</b>
<b>Parameters:</b>	Rated voltage/frequeency: 230 VAC 50 Hz Rated power : 500-1000 W Protection class : II IP Class : IPX6
<b>Product Tested and Inspected according to:</b>	Low Voltage Directive 2006/95/EC IEC 60335-1 :2010 IEC 60335-2-30 : 2009

This Attestation of Conformity is issued on a voluntary basis according to Low Voltage Directive 2006/95/EC. It conforms that the listed equipment complies with the principal protection requirements of the directive. It refers only to the particular sample and its technical documentation submitted for inspection.

<b>Test Report No.:</b>	<b>TGK-LTMP-13-064</b> ( LVD-2013267)
<b>Issue Date :</b>	<b>2013-12-25</b>



After preparation of the necessary technical documentation as well as the conformity declaration the required CE marking can be affixed on the product. Other relevant directives have to be observed.

**Page 1 of 1**

K03-E06-S02, Issue Date: 07.03.2008, Rev: 02 , Rev. Date: 06.03.2008